

SF/SA 60Hz SERIES

SUBMERSIBLE STAINLESS
STEEL PUMPS



50SFU2.4A/2.8A

80SFU21.5/22.2/23.7

80SFU25.5/27.5/211

80SFP21.5/22.2/23.7

80(100)SFP25.5/27.5
80(100)SFP211/215

SF *Stainless Steel Sewage / Wastewater Submersible Pump*
SA *Stainless Steel Wastewater / Effluent Submersible Pump*

FEATURES

- Precision casting with the use of an advanced stainless investment casting method, produces the highest quality with a smooth surface finish.
- Standard accessories include : cable with an epoxy resin sealed water-resistant cable base, Auto-cut motor protector, dual mechanical seals and oil seal design.
- Chemically protected Viton O-rings to handle acidic and corrosive fluids.
- Pump hydraulic body made of corrosion resistant SUS316/SCS14 stainless steel material, to handle low pH value chemical media and/or seawater applications.
- Austenitic Stainless Steel(SUS300 series)is used in SF/SA series. SUS316/SCS14 is better than SUS304/SCS13 in water application of light acid-base.
- pH2~10 (As reference at operating temperature range 0 - 40°C)

APPLICATIONS

- Wastewater treatment in food and wine-making industry.
- Wastewater treatment of acid fluid in gold mining, petroleum industry and dyeing industry.
- Chemicals, low pH, corrosive and sea water applications.



U Type Vortex Impeller

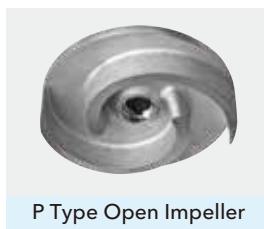

P Type Open Impeller

PRODUCT NOMENCLATURE

80	SF	P	2	3.7
Discharge mm	Type	Impeller type	Pole	kW
50	SA	2	8	A
Discharge mm	Type	Pole	kW	Style

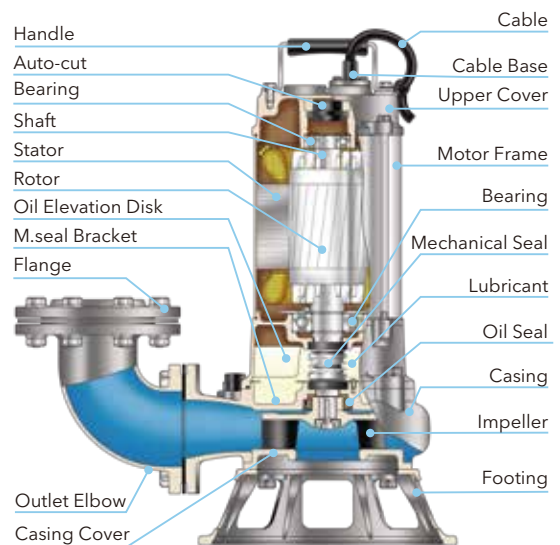

ACCESSORIES :
ELBOW / GRS - GUIDE RAIL SYSTEMS

SF/SA pumps can be installed with 90° Elbow Flange outlet or GRS guide rail system, to have easier / safer installation or removal during replacement and maintenance.





PERFORMANCE CURVES

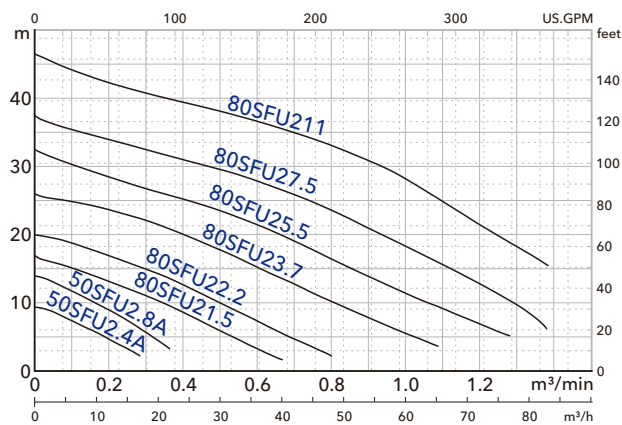
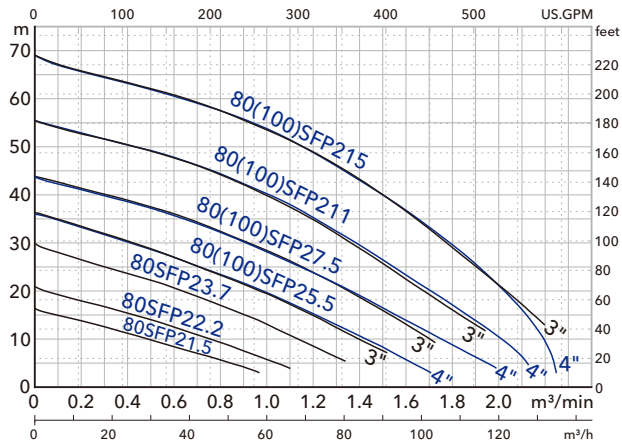

SPECIFICATIONS

Item	Description	
Limits of Use	Liquid Temp.	0~40°C (32~104°F)
	Applications	Corrosive • Food • Processing Liquids
Type	Frequency	60Hz
	Motor	2P(3600rpm) • Dry Motor
	Insulation	Class B (0.5~1HP) • Class F (2~5HP) • Class H (7.5~20HP)
	Protection	IP68
	Protector	Thermal (0.5HP 1Ø) • Auto-cut (0.5HP 3Ø ~10HP) • MTS & MS(15~20HP)
	Bearing	Ball type
	M.seal	Double M.seals
Material	Impeller	Vortex • Open
	Upper Cover	SCS14 / A744 CF-8M
	Motor Frame	SUS316 / AISI 316
	Shaft	SUS316 / AISI 316 (0.5~10HP) • SUS630 / AISI 630 (15~20HP)
	M.seal	CA/CE & SiC/SiC
	O-ring	Viton
	Casing	SCS14 / A744 CF-8M
	Impeller	SCS14 / A744 CF-8M
Optional	Pump can be customized to fit specifications	

PERFORMANCE SPECS.

※ Note : Weight Without Cable & Elbow Set
Star Method: Y-D = STAR-DELTA.

	Model	Output HP(kW)	Discharge Inch(mm)	Phase Ø	Start Method	Standard		Solid Passage mm(inch)	Weight kg(lb)		Dimensions (mm)				
						m-m³/min	ft-GPM		1Ø	3Ø	A	B	C	D	
												1Ø	3Ø		
U Type	50SFU2.4A	0.5(0.4)	2"(50)	1/3	Capacitor DOL	5.5-0.15	18-40	35(1 3/8")	15(33)	14(31)	237	-	153	432	432
	50SFU2.8A	1(0.75)	2"(50)	1/3	Capacitor DOL	8-0.2	26.2-52	35(1 3/8")	16(35)	15(33)	237	-	153	432	432
	80SFU21.5	2(1.5)	3"(80)	1/3	Capacitor DOL	8-0.4	26.2-105	50(2")	30(66)	26(57)	402	260	202	586	517
	80SFU22.2	3(2.2)	3"(80)	1/3	Capacitor DOL	12.5-0.4	41-105	50(2")	34(75)	29(64)	402	260	202	598	517
	80SFU23.7	5(3.7)	3"(80)	3	DOL	17.5-0.5	57.4-132	50(2")	-	39.5(87)	476	286	222	-	561
	80SFU25.5	7.5(5.5)	3"(80)	3	DOL	21.5-0.6	70.5-158	50(2")	-	60(132)	499	309	258	-	657
	80SFU27.5	10(7.5)	3"(80)	3	DOL	27-0.6	88.6-158	50(2")	-	66(146)	499	309	258	-	657
	80SFU211	15(11)	3"(80)	3	Y-D / DOL	36.5-0.6	119.8-158	50(2")	-	75(165)	499	309	258	-	697
P Type	80SFP21.5	2(1.5)	3"(80)	1/3	Capacitor DOL	8-0.6	26.2-158	35(1 3/8")	32(71)	28(62)	417	275	260	590	521
	80SFP22.2	3(2.2)	3"(80)	1/3	Capacitor DOL	12.5-0.6	41-158	35(1 3/8")	36(79)	31(68)	417	275	260	602	521
	80SFP23.7	5(3.7)	3"(80)	3	DOL	20.5-0.6	67.3-158	32(1 1/4")	-	42.5(94)	495	305	290	-	568
	80(100)SFP25.5	7.5(5.5)	3"(80) 4"(100)	3	DOL	26.5-0.6 20-1.0	86.9-158 65.6-264	30(1 1/8")	-	66(146)	563 591	373	345	-	684
	80(100)SFP27.5	10(7.5)	3"(80) 4"(100)	3	DOL	35.5-0.6 28-1.0	116.5-158 91.9-264	30(1 1/8")	-	72(159)	563 591	373	345	-	684
	80(100)SFP211	15(11)	3"(80) 4"(100)	3	Y-D / DOL	47-0.6 39.5-1.0	154.2-158 129.6-264	30(1 1/8")	-	81(179)	563 591	373	345	-	724
	80(100)SFP215	20(15)	3"(80) 4"(100)	3	Y-D / DOL	58-0.7 48-1.2	190.3-185 157.5-315	30(1 1/8")	-	91(201)	563 591	373	345	-	764

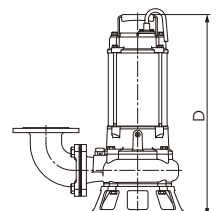
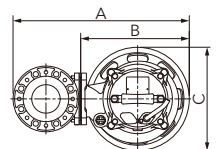



PERFORMANCE CURVES

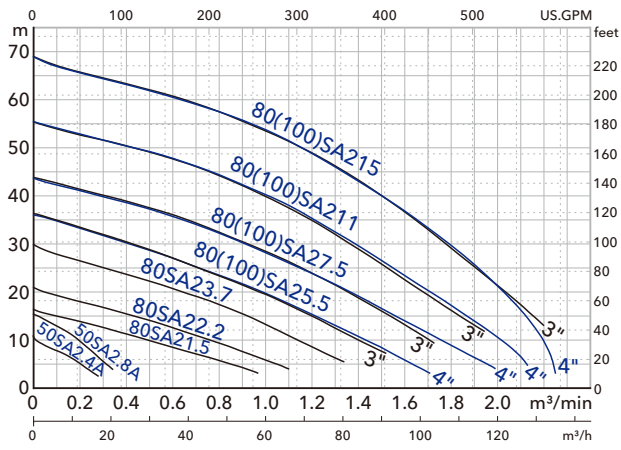

80(100)SA25.5/27.5
80(100)SA211/215



80SA21.5/22.2/23.7



50SA2.4A/2.8A

PERFORMANCE SPECS.

※ Note : Weight Without Cable & Elbow Set
Star Method : Y-D = STAR-DELTA.

Model	Output HP(kW)	Discharge Inch(mm)	Phase Ø	Start Method	Standard		Solid Passage mm(inch)	Weight kg(lb)		Dimensions (mm)				
					m-m³/min	ft-GPM		1Ø	3Ø	A	B	C	D	
50SA2.4A	0.5(0.4)	2"(50)	1 3	Capacitor DOL	6.5-0.15	21.3-40	10(3/8")	14(31)	14(31)	244	-	172	435	435
50SA2.8A	1(0.75)	2"(50)	1 3	Capacitor DOL	10-0.17	32.8-45	10(3/8")	16(35)	15(33)	244	-	172	435	435
80SA21.5	2(1.5)	3"(80)	1 3	Capacitor DOL	8-0.6	26.2-158	20(3/4")	33(73)	29(64)	390	248	212	589	520
80SA22.2	3(2.2)	3"(80)	1 3	Capacitor DOL	12.5-0.6	41-158	20(3/4")	37(82)	32(71)	390	248	212	601	520
80SA23.7	5(3.7)	3"(80)	3	DOL	20.5-0.6	67.3-158	20(3/4")	-	44(97)	465	275	239	-	568
80(100)SA25.5	7.5(5.5)	3"(80) 4"(100)	3	DOL	26.5-0.6 20-1.0	86.9-158 65.6-264	20(3/4")	-	66(146)	528 556	338	286	-	684
80(100)SA27.5	10(7.5)	3"(80) 4"(100)	3	DOL	35.5-0.6 28-1.0	116.5-158 91.9-264	20(3/4")	-	72(159)	528 556	338	286	-	684
80(100)SA211	15(11)	3"(80) 4"(100)	3	Y-D / DOL	47-0.6 39.5-1.0	154.2-158 129.6-264	20(3/4")	-	81(179)	528 556	338	286	-	724
80(100)SA215	20(15)	3"(80) 4"(100)	3	Y-D / DOL	58-0.7 48-1.2	190.3-185 157.5-315	20(3/4")	-	94(207)	528 556	338	286	-	764

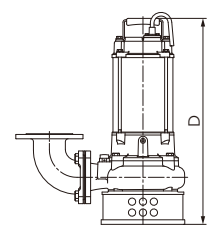
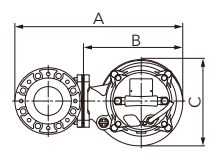

Professionalism • Innovation • Service • Commitment
HCP PUMP MANUFACTURER CO., LTD.
www.hcppump.com



Distributor:

We reserve the right to alter specifications of product at any time without giving prior notice.
 Copyright © 2023 HCP PUMP MANUFACTURER CO., LTD. All rights reserved.